

## Changing the filter

⚠ These short operating instructions are not a replacement for the instructions for use. In the interests of safety, always read the safety information and warnings first.

### 1 - "Filter" symbol lights up

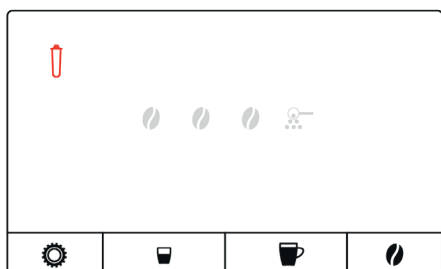

### 2 - Remove the water tank

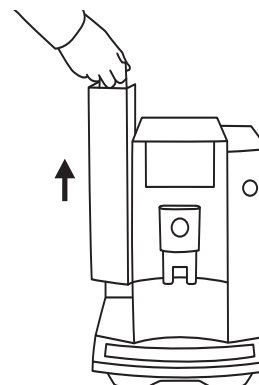

### 3 - Empty water tank

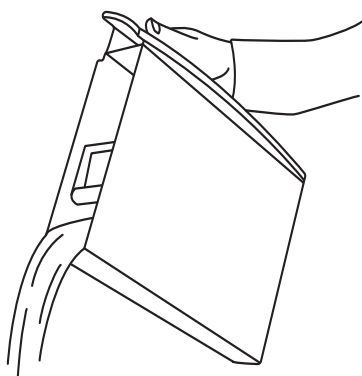

### 4 - Turn the filter

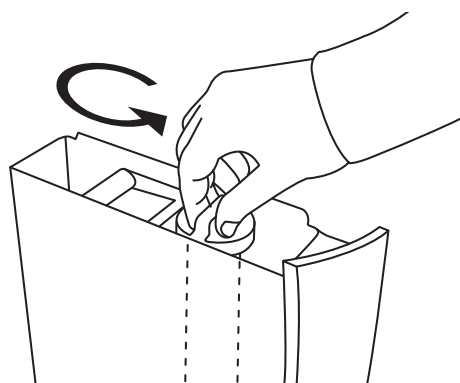

### 5 - Remove the filter

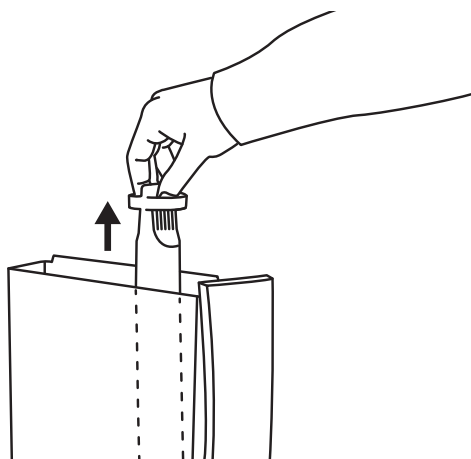

### 6 - Place the extension on the new filter cartridge

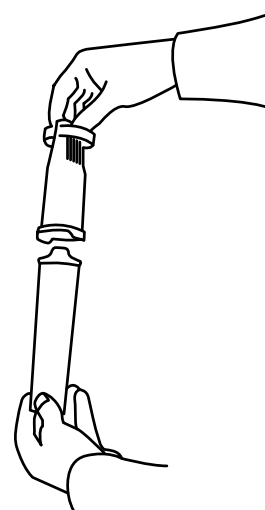

## Changing the filter

⚠ These short operating instructions are not a replacement for the instructions for use. In the interests of safety, always read the safety information and warnings first.

7 - Insert the filter

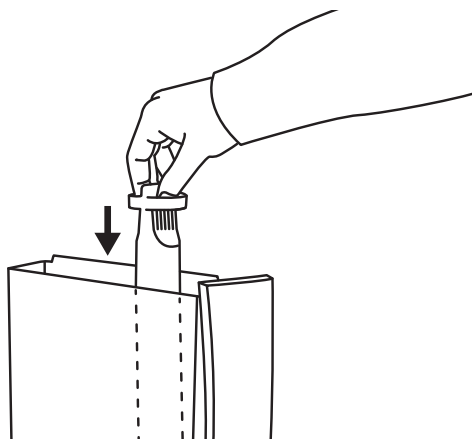

8 - Turn the filter

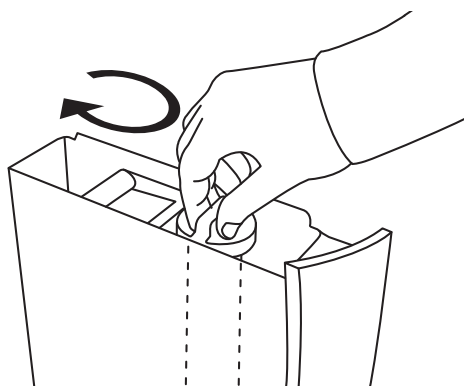

9 - Fill the water tank

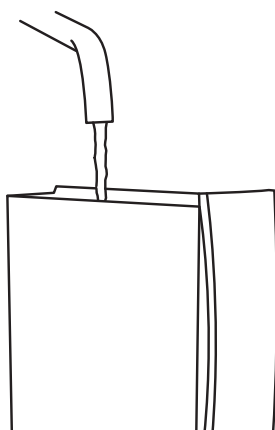

10 - Insert the water tank

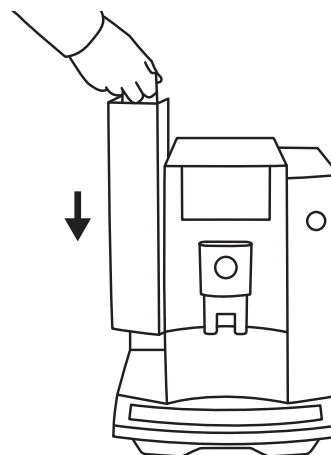

11 - Symbols flash from right to left



12 - Place the receptacle under the hot-water spout

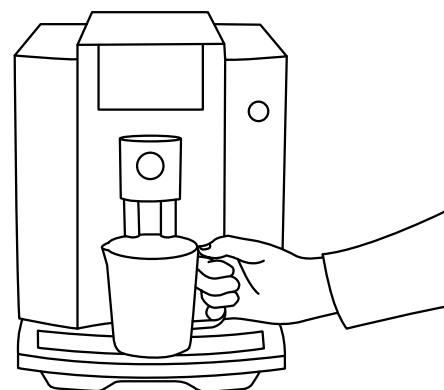

## Changing the filter

⚠ These short operating instructions are not a replacement for the instructions for use. In the interests of safety, always read the safety information and warnings first.

13 - Turn the switch anticlockwise

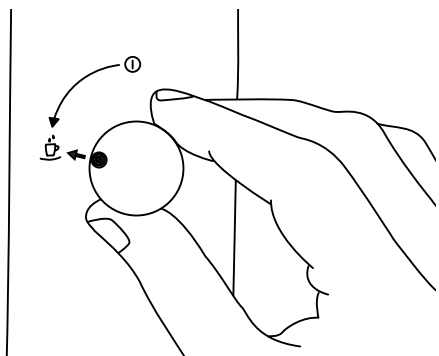

14 - Water flows out of the hot-water spout

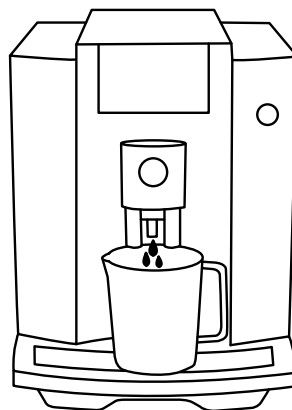

15 - Symbols flash from left to right

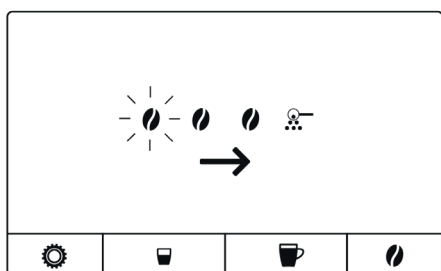

16 - Turn the switch clockwise

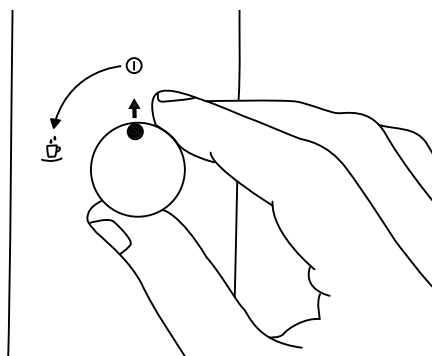

17 - "Drip tray" symbol lights up



18 - Remove the drip tray

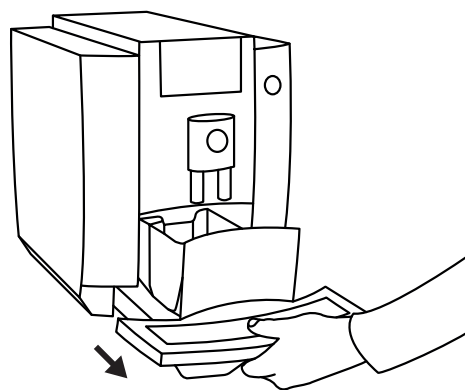

## Changing the filter

⚠ These short operating instructions are not a replacement for the instructions for use. In the interests of safety, always read the safety information and warnings first.

### 19 - Empty the drip tray

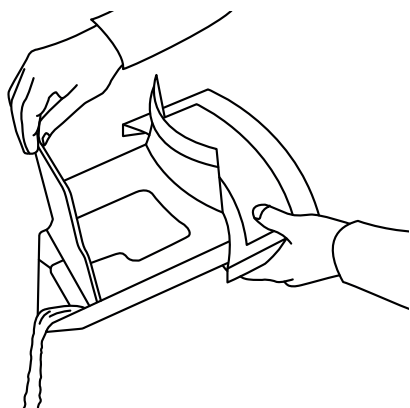

### 20 - Empty the coffee grounds container

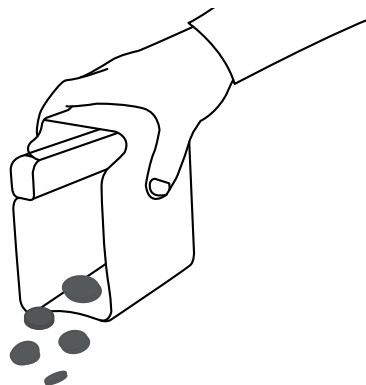

### 21 - Insert the drip tray

